

T-Link-WIFI-U-100

User Manual

V1.0.0

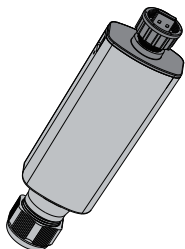

Warning: Please read the instructions before use!

Product Overview

T-Link-WIFI-U-100 is a smart data collection device developed by TBEA. It is used to collect the operating data of inverters and upload the data to the cloud.

T-Link-WIFI-U-100 connector type:

- ☐ USB connector

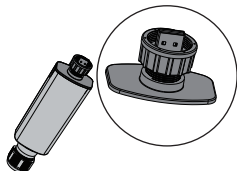

Product Features

- Remote firmware update
- Network diagnosis
- LED indicators
- Plug-in and Play
- Automatic resumption of data transmission upon network recovery
- IP66 rated enclosure protection

Product Schema

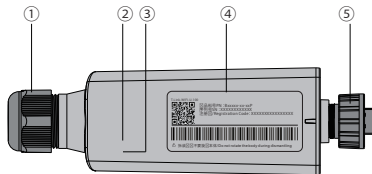

- ① Bolt: locks the network cable
- ② Blue LED: Indicator for network communication
- ③ Green LED: Indicator for inverter communication
- ④ Product label: shows product information
- ⑤ Rotating nut: stick connection to the inverter

Note: LED will light up only after stick is powered on.

Packing List

No	Name	Quantity
1	Stick	1
2	User Manual	1

Installation Guide

Press the snaps on both sides of the stick to open the casing (Note: try not to touch the PCBA component)

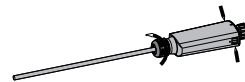

Unscrew the bolt and pull out the rubber plug, pass the network cable head successively through the nut, rubber plug, case, and then into the network port.

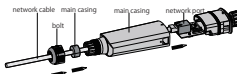

Fasten the main casing, insert the rubber plug, and tighten the screw in sequence to complete network cable installation.



*Only use a network cable without a protection cap as the cap will not fit into the connector.



Please remove the anti-dust cap of the connector on the inverter by rotating counterclockwise.

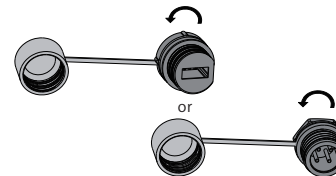

Insert the stick and tighten the floating screw clockwise. As shown below.

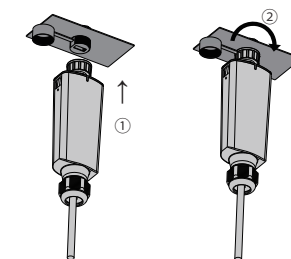

To remove the Stick from the inverter, turn the floating screw counterclockwise as shown in the figure below. After removing the stick, tighten the anti-dust cap clockwise to ensure inverter protection.

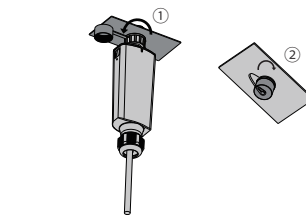

Caution: Please do not rotate the body of the stick during installation or removal.

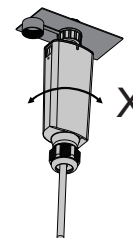

Plant Monitoring

Account registration and plant creation

Open the APP, after completing account registration and having logon, create a power plant. For details, please refer to the APP user manual.

Network Connection

- If using Ethernet (wired) connection, please connect to the non-POE port or standard POE port, please do not access to the non-standard POE port, so as not to damage the collector.
- If using wireless connection, please make sure to disconnect the Ethernet (wired), and can only support network with 2.4GHz bandwidth, please do not turn on the multi-band function of the wireless router.

LED indicators and troubleshooting

Green LED: Inverter communication indicator

- Green LED is off: stick hardware fault, please contact our service.
- Green LED is on: Data collection is normal.

Blue LED: Network communication indicator

- Blue LED is off: stick is not connected to the cloud server. Try to restarting or contacting our service.
- Blue LED is blinking: The T-Link-WIFI-U-100 has connected to the router and obtained an address, but cannot connect to the cloud. Please check your router configuration or contact our after-sales service.
- Blue LED light stays on: the T-Link-WIFI-U-100 is connected to the cloud server.

Warranty

Thank you for purchasing the T-Link-WIFI-U-100 from TBEA Xi'an Electric Technology Co., Ltd. Please keep this warranty card carefully, so that you could enjoy our full-service benefits.

Filled in the customer:

User name		Contact person	
Product name		Purchase date	
Serial number			
Contact number			
Address			
Order number			
Service information	Date	Description	

Warranty description

Please send the faulty device and warranty card together back to TBEA service center in case of quality issues.

Note

1. From the date on the purchasing invoice, any quality issue which happens within warranty period will be fully covered by the warranty.

2. The warranty does not cover damages that occur due to incorrect installation, commission, inappropriate storage and other unreasonable factors.

Contact

TBEA Xi'an Electric Technology Co., Ltd.
Add.: No.70 Shanglinyuan 4th Road, High-tech Zone,
Xi'an, China

Qualification Certification

This product has passed the factory quality check control